

Application Guide

Zfx Luminations **Zml** Metal **Sfx** Counterpointe Sandtone

Getting Started

Application Tips

Application Temperature: 50° - 85° F

Spread Rate: Up to 90-110 square feet per gallon. Depending on surface porosity and texture, size of pattern and method of application.

Drying Time: 2-4 Hours Depending on humidity and temperature
Full film integrity at 7-10 days.

Ambient Light conditions will have an effect on the final appearance. Use proper lighting while applying.

Mock Up Wall

Zolatone recommends applying a mock up area to be approved by the specifier before beginning general application.

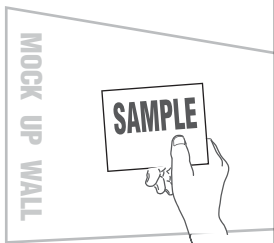

A. Wall Prep

Recommended Minimum Drywall Finish

5 White *blanco*

DO NOT TINT PRIMER
ZOLATONE PRIMER MUST BE WHITE

Water-soluble stains should be spot primed with Zolatone Primer SP235 prior to general priming.

B. Mixing

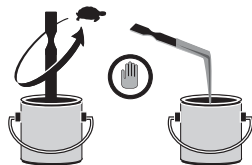

Stir by hand with a gentle rolling motion, box or mix using hand mixer.



DO NOT USE A MECHANICAL AGITATOR

C. Thinning

SPRAY

ONLY IF NECESSARY

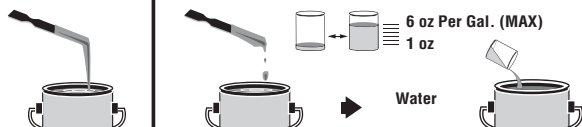

If you think it is necessary to thin your Zolatone product, stop and call customer service. You will be helped by Technical Service. **1-800-765-6699**

Equipment

FLUID NEEDLE 565

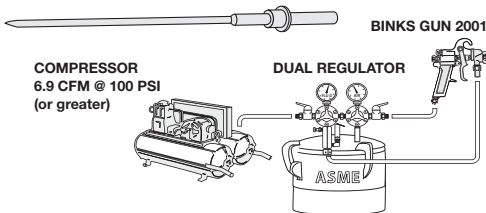

COMPRESSOR
6.9 CFM @ 100 PSI
(or greater)

DUAL REGULATOR

BINKS GUN 2001

NOZZLE TIP 200

FLUID NOZZLE 66SS

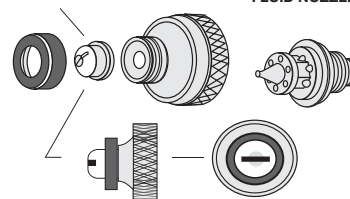

Application Speed



Spraying too rapidly may result in a non-uniform appearance.



I. Sheer Coat

(1) FLUID PRESSURE

FLUID	AIR	CFM
70 psi	55-60 psi	6.9
80 psi	65-70 psi	8.0
90 psi	75-80 psi	20

(2) AIR PRESSURE

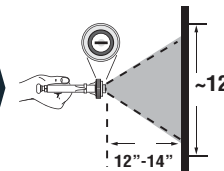

Set air pressure with gun half-triggered.

1 COAT = 2 PASSES

1st PASS (paso) - Horiz. 2nd PASS (paso) - Vert.

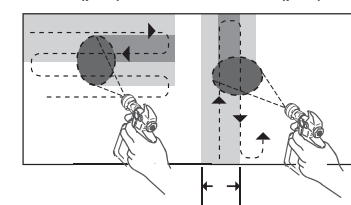

50% overlap.



DRY TO TOUCH



2. Pattern Coat

LOWER AIR PRESSURE
Fluid pressure remains the same

AIR PRESSURE
45-50 psi
55-60 psi
65-70 psi

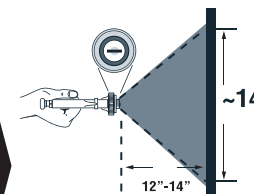

Application Speed



Pattern Coating application slightly faster

Use Same Two-Pass Application

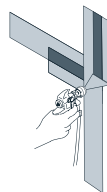

1st Pass - Horiz.

2nd Pass - Vert.

1 COAT = 2 PASSES

Trouble Shooting

- Wall Does Not Match Jobsite Standard: Without a (A) white primed surface, (1) sheer coat and (2) pattern coat, the wall will not match the jobsite standard, and the integrity and reparability of the Zolatone product is compromised. Always use the 3 step system.
- Line and Lap Marks: The sheer step is not being atomized and the primer is showing through the multicolor film. Recheck the fluid control knob adjustment and air to paint pressure settings. Always judge the uniformity of the sheer step after it is "dry-to-touch" before applying the pattern step.
- Particle size too small: Recheck the fluid control knob restriction setting and lower the air pressure "atomization" to provide a larger particle.
- Particle size too large: Adjust air pressure "atomization" higher to provide a smaller particle.

Visit www.zolatone.com for more information

All settings represent working pressures (i.e., when the gun is triggered). The true measure of proper equipment settings is in the final result on the wall. Pressures shown above are guidelines. Your actual settings may vary due to equipment differences, temperature of the material, environment and the work height.

For complete product data sheets, guide specs, LEED compliance and MSDS visit www.zolatone.com or call **1-800-765-6699**



If you are not clear on any part of this application, **STOP and call!** **1-800-765-6699**

© 2008 Master Coating Technologies
Master Coating Technologies is a member of the USGBC and the CaGBC
MCT Corporate Offices:
2777 Eagandale Boulevard
Eagan, MN 55121

zolatone